

# 1851

## Tube sight glass

PN 10 DN 25-100

### Design

Straight pattern  
Jammed glass tube

### Valve ends

Flanges acc. to  
EN 1092-1 (DIN 2501  
Part 1)

### Requirements and tests

Acc. to DIN 3230 Part 1

### Marking

Nominal size DN  
Nominal pressure PN  
Flange material  
Manufacturer brand  
Flow direction arrow

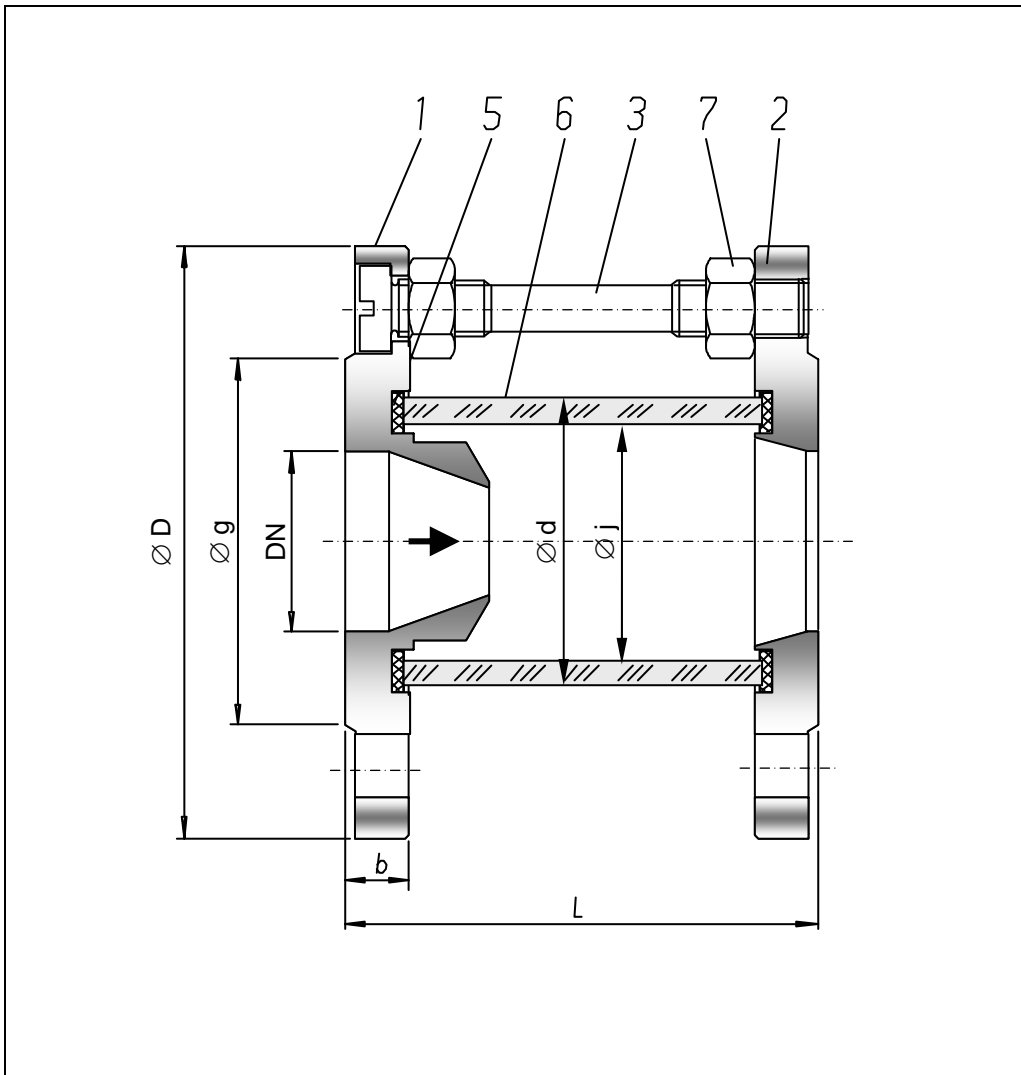

#### Pos. Denomination Material

	1.4541	1.4571
1 Inlet flange	1.4541	1.4571
2 Outlet flange	1.4541	1.4571
3 Stud bolt	1.4541	1.4571

#### Pos. Denomination Material

	1.4541	1.4571
5 Gasket	Graphite / 1.4401	Graphite / 1.4401
6 Glass tube	Duran 50	Duran 50
7 Hex. nut	A2	A4

#### Face-to-face dimension as per works standards

DN	25	32	40	50	65	80	100
L	110	120	130	130	150	150	180
D	115	140	150	165	185	200	220
g	68	78	88	102	122	138	158
b	16	16	18	18	18	20	20
d	55	60	70	80	100	120	140
j	45	50	56	66	82	102	140
kg							

**Pressure/Temperature ratings in bar g at Temperature in °C**

<b>Material</b>	<b>PN</b>	<b>50°C</b>	<b>100°C</b>	<b>120°C</b>	<b>150°C</b>	<b>200°C</b>	<b>250°C</b>	<b>300°C</b>					
»1.4541« X6CrNiTi18-10 EN 10028-7	<b>10</b>	10,0	10,0	10,0	10,0	9,4	8,8	8,1					
»1.4571« X6CrNiMoTi17-12-2 EN 10028-7	<b>10</b>	10,0	10,0	10,0	10,0	10,0	9,4	8,7					

**Modifications**

Inlet- and outlet port drilled to the inner glass diameter (Non dead space)  
Chip guard

**Installation**

Piping is to be done in such a manner that injurious thrust and bending forces are kept away from the valve casings. Depending on the view and the flow direction, tube sight glasses can be installed in each position.